

Cable Kit 3224 Interface 3009/49

Mimer SoftRadio – Sepura SRG3900

Remote functionality

This cable kit will together with the Mimer Network Interface give remote control of the radio's audio and PTT functions and it will present a full function Virtual Control Head.



Both a Sepura radio terminal and a control head is needed.

Radio programming

No special programming is needed.

Cable Kit

The red wire on the cable kit shall be connected to +12V and the black to ground.

Connection

The radio shall be powered through this cable kit instead of the standard power cable to avoid hum and noise.

Connect the interface to both the standard control head and to the radio unit.



Sepura SRG with Network Interface and cable kit

Virtual Control Head functions

The Virtual Control Head is a copy of the modern color screen type control head.

The full display is presented exactly as it is on the radio, and all keys work as they do on the ordinary control head.

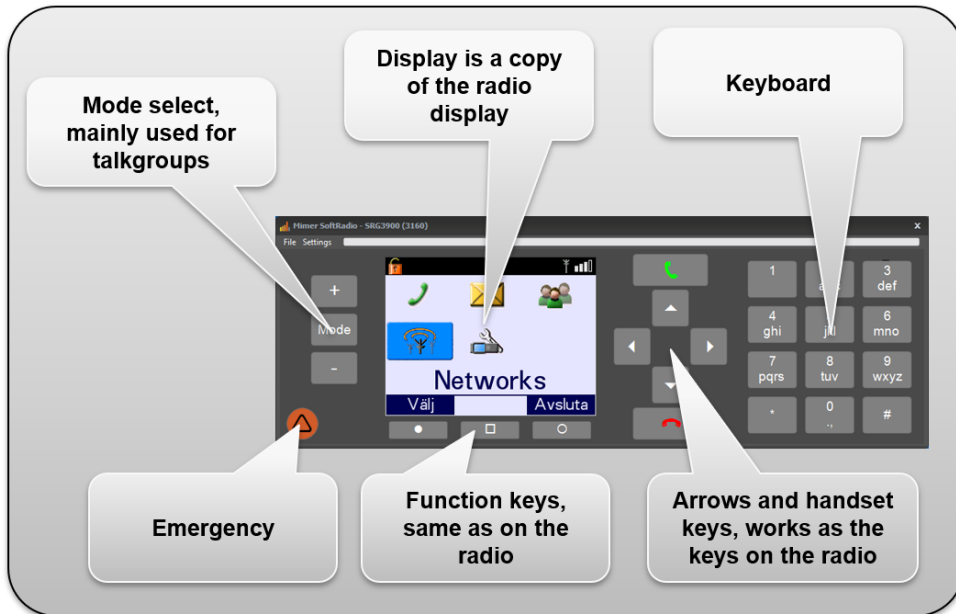

Please note that the +/- keys sets the volume level in the same way as it does on the radios front panel. To avoid changing the volume for all operators that share the same radio, please leave the volume at 2/3 of max volume and use SoftRadio's volume control for adjustments.

Alternatively reprogram the SRG to have a fixed volume that can't be changed from the control head.

Control Head Style

On the virtual control Head "Settings"-menu you can select two layout types, representing the different control head styles.

